



## 20. Potentiometer inputs – resistance–converter

Principle of a galvanic insulation and reminders concerning I.S.

General specifications for galvanic insulation interfaces

Selection guide

Use of galvanic insulation

Table of equivalent references according to type of assembly

Ref.	Description (see technical data sheet for further information)		IS parameters ATEX marking																									
BXNP	The BXNP is a converter for potentiometers. When ordering, specify the input scale and output.																											
	<table border="1"> <thead> <tr> <th>Type</th> <th>Input</th> <th>Option</th> <th>Power supply</th> <th>Output</th> </tr> </thead> <tbody> <tr> <td>BXNP</td> <td>0-1 K<math>\Omega</math> to 0-50 K<math>\Omega</math> 4 mA adjustable within 0-30% of the range 20 mA adjustable within 70-100% of the range</td> <td>00 No option B0 Screw terminals</td> <td>0 230 V AC 1 110 V AC 3 24 V DC 4 48 V DC</td> <td>B0 Active 4/20 mA</td> </tr> <tr> <td>**</td> <td>Other on request</td> <td></td> <td></td> <td></td> </tr> </tbody> </table>	Type	Input	Option	Power supply	Output	BXNP	0-1 K $\Omega$ to 0-50 K $\Omega$ 4 mA adjustable within 0-30% of the range 20 mA adjustable within 70-100% of the range	00 No option B0 Screw terminals	0 230 V AC 1 110 V AC 3 24 V DC 4 48 V DC	B0 Active 4/20 mA	**	Other on request						<p><b>HJ terminals:</b>  <b>U<sub>o</sub>:</b> 12.5 V  <b>I<sub>o</sub>:</b> 80 mA  <b>P<sub>o</sub>:</b> 600 mW  <b>C<sub>o</sub>, IIC:</b> 1200 nF  <b>L<sub>o</sub>, IIC:</b> 5 mH</p> <p><b>JL terminals:</b>  <b>U<sub>o</sub>:</b> 12.5 V  <b>I<sub>o</sub>:</b> 2.4 mA  <b>P<sub>o</sub>:</b> 15 mW  <b>C<sub>o</sub>, IIC:</b> 1200 nF  <b>L<sub>o</sub>, IIC:</b> 1000 mH</p> <p><b>Marking:</b>            II(1)G [Ex ia] IIC            II(1)D [Ex iaD] IIC            Certificate:            02ATEX6104X</p>									
Type	Input	Option	Power supply	Output																								
BXNP	0-1 K $\Omega$ to 0-50 K $\Omega$ 4 mA adjustable within 0-30% of the range 20 mA adjustable within 70-100% of the range	00 No option B0 Screw terminals	0 230 V AC 1 110 V AC 3 24 V DC 4 48 V DC	B0 Active 4/20 mA																								
**	Other on request																											
BXNRV	The BXNRV is used to interface a 2-wire variable resistance.																											
	<table border="1"> <thead> <tr> <th>Type</th> <th>Input</th> <th>Option</th> <th>Power supply</th> <th>Output</th> </tr> </thead> <tbody> <tr> <td>BXNC</td> <td>V1 4 mA adjustable between 270 and 330<math>\Omega</math> 20 mA adjustable between 850 and 1700<math>\Omega</math></td> <td>00 No option B0 Screw terminals</td> <td>0 230 V AC 1 110 V AC 3 24 V DC 4 48 V DC</td> <td>00 Active 4/20 mA 03 Active 0/20mA 08 0/5 V A0 Passive 4/20 mA XX Others on request</td> </tr> <tr> <td>V5</td> <td>4 mA adjustable between 3900 and 5500<math>\Omega</math> 20 mA adjustable between 8200 and 11200<math>\Omega</math></td> <td></td> <td></td> <td></td> </tr> <tr> <td>V6</td> <td>4 mA adjustable between 0 and 750<math>\Omega</math> 20 mA adjustable between 6000 and 7500<math>\Omega</math></td> <td></td> <td></td> <td></td> </tr> <tr> <td>**</td> <td>Other on request</td> <td></td> <td></td> <td></td> </tr> </tbody> </table>	Type	Input	Option	Power supply	Output	BXNC	V1 4 mA adjustable between 270 and 330 $\Omega$ 20 mA adjustable between 850 and 1700 $\Omega$	00 No option B0 Screw terminals	0 230 V AC 1 110 V AC 3 24 V DC 4 48 V DC	00 Active 4/20 mA 03 Active 0/20mA 08 0/5 V A0 Passive 4/20 mA XX Others on request	V5	4 mA adjustable between 3900 and 5500 $\Omega$ 20 mA adjustable between 8200 and 11200 $\Omega$				V6	4 mA adjustable between 0 and 750 $\Omega$ 20 mA adjustable between 6000 and 7500 $\Omega$				**	Other on request					
Type	Input	Option	Power supply	Output																								
BXNC	V1 4 mA adjustable between 270 and 330 $\Omega$ 20 mA adjustable between 850 and 1700 $\Omega$	00 No option B0 Screw terminals	0 230 V AC 1 110 V AC 3 24 V DC 4 48 V DC	00 Active 4/20 mA 03 Active 0/20mA 08 0/5 V A0 Passive 4/20 mA XX Others on request																								
V5	4 mA adjustable between 3900 and 5500 $\Omega$ 20 mA adjustable between 8200 and 11200 $\Omega$																											
V6	4 mA adjustable between 0 and 750 $\Omega$ 20 mA adjustable between 6000 and 7500 $\Omega$																											
**	Other on request																											
	<ol style="list-style-type: none"> <li>Presence of voltage indicated by a green LED</li> <li>Adjustment potentiometers for the source and the curve of the 4/20 mA output</li> </ol>																											





Explanatory diagram

I/O

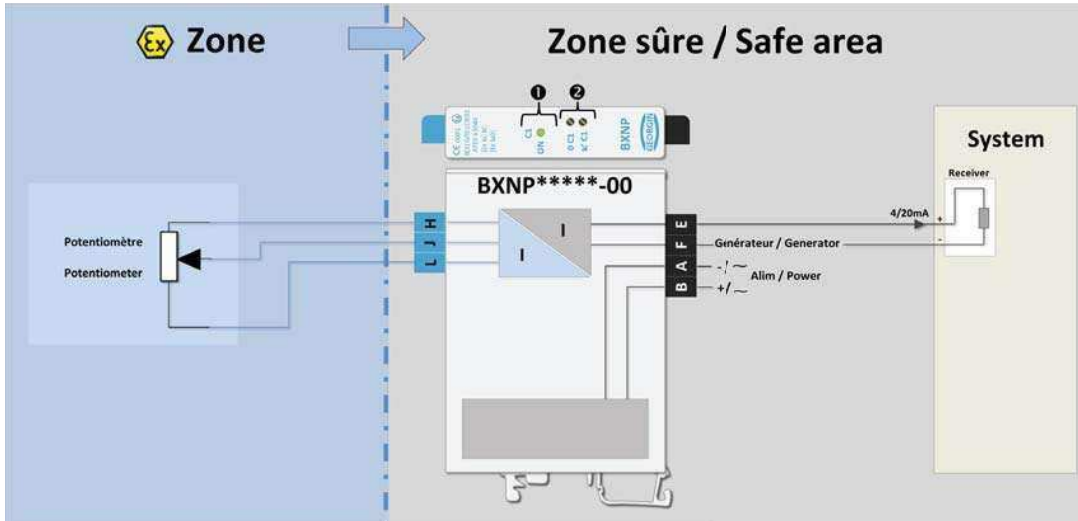

1 Pot. Input / 1 Output

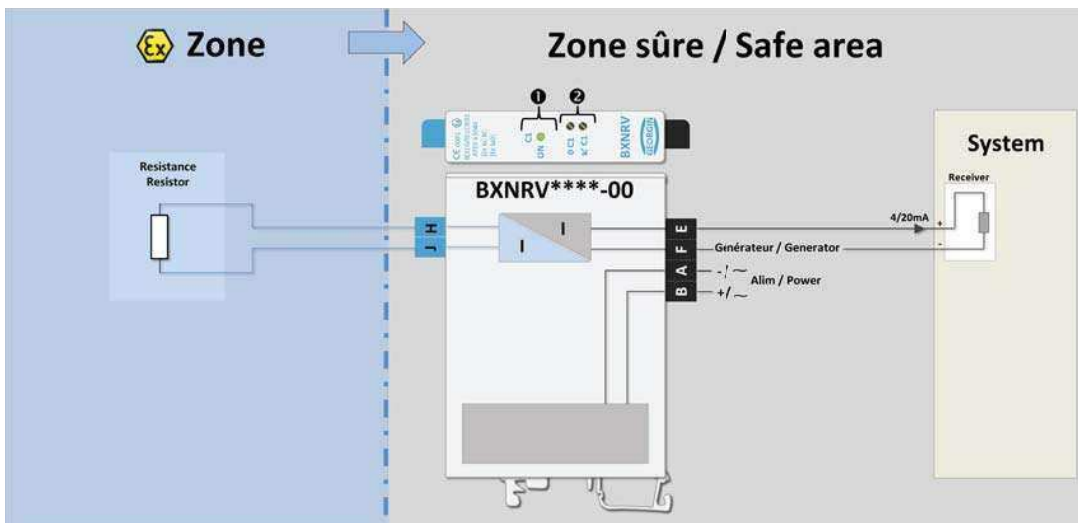

1 resistance Input / 1 Output

Principle of a galvanic insulation and reminders concerning I.S.

General specifications for galvanic insulation interfaces

Selection guide

Use of galvanic insulation

Table of equivalent references according to type of assembly